

# TensionLite Wave Shape Mini-Wall Design 1200

TensionLite Wave Shape banner displays feature basic tubular frames coupled with pillowcase fabric graphics. The economy tube frames come with a one year limited warranty. Simply pull the graphic over the frame.



We are continually improving and modifying our product range and reserve the right to vary the specifications without prior notice. All dimensions and weights quoted are approximate and we accept no responsibility for variance. E&OE. See Graphic Templates for graphic bleed specifications.

## features and benefits:

- Curved aluminum tube frame
- Easy to store and ship
- Quick to set up
- Pillowcase fabric graphic
- Carry bag included
- Bungee cords for easy assembly
- One year limited hardware warranty against manufacturer defects

## dimensions:

| Hardware   | Graphic  |
|--|--|
| <p>Assembled unit:<br/>47.24"w x 92"h x 23.96"d 1200mm(w) x 2337mm(h) x 609mm(d)</p> <p>Approximate weight (includes graphic):<br/>13 lbs / 5.9 kg</p>   | <p>Refer to related graphic template for more information.</p> |
| <p>Shipping</p> <p>1 carry bag</p> <p>Shipping dimensions (box):<br/>58"l x 13"w x 13"h<br/>1473mm(l) x 330mm(w) x 330mm(h)</p> <p>Approximate shipping weight (includes carry bag and graphic): 18 lbs / 8.2 kg</p> |  |
| <h3>additional information:</h3>   |  |
| <p>Graphic material:<br/>dye-sublimated slip-over graphics</p>   |  |

# Included in your design

## Hardware



6MM HEX KEY x1



WVC-PLATE-STD x2



LN114-SCRW x2  
(included with  
Bungee Assembly)

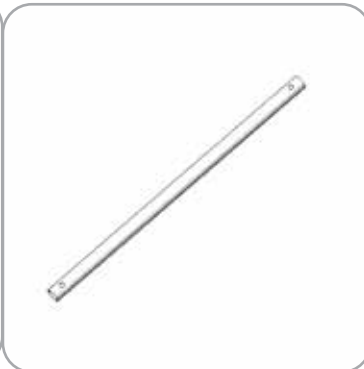

ESS-SPREADER-LS-1200-S x2



Bungee Assembly x1

## Graphics

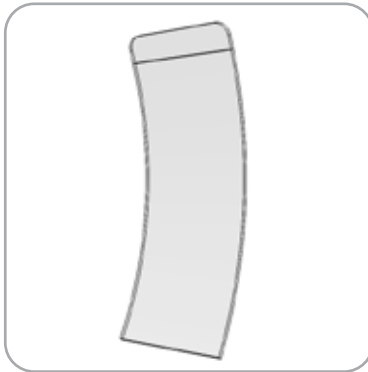

FMLT-ESS-C-1200-G x1

# Exploded View



OVERHEAD VIEW

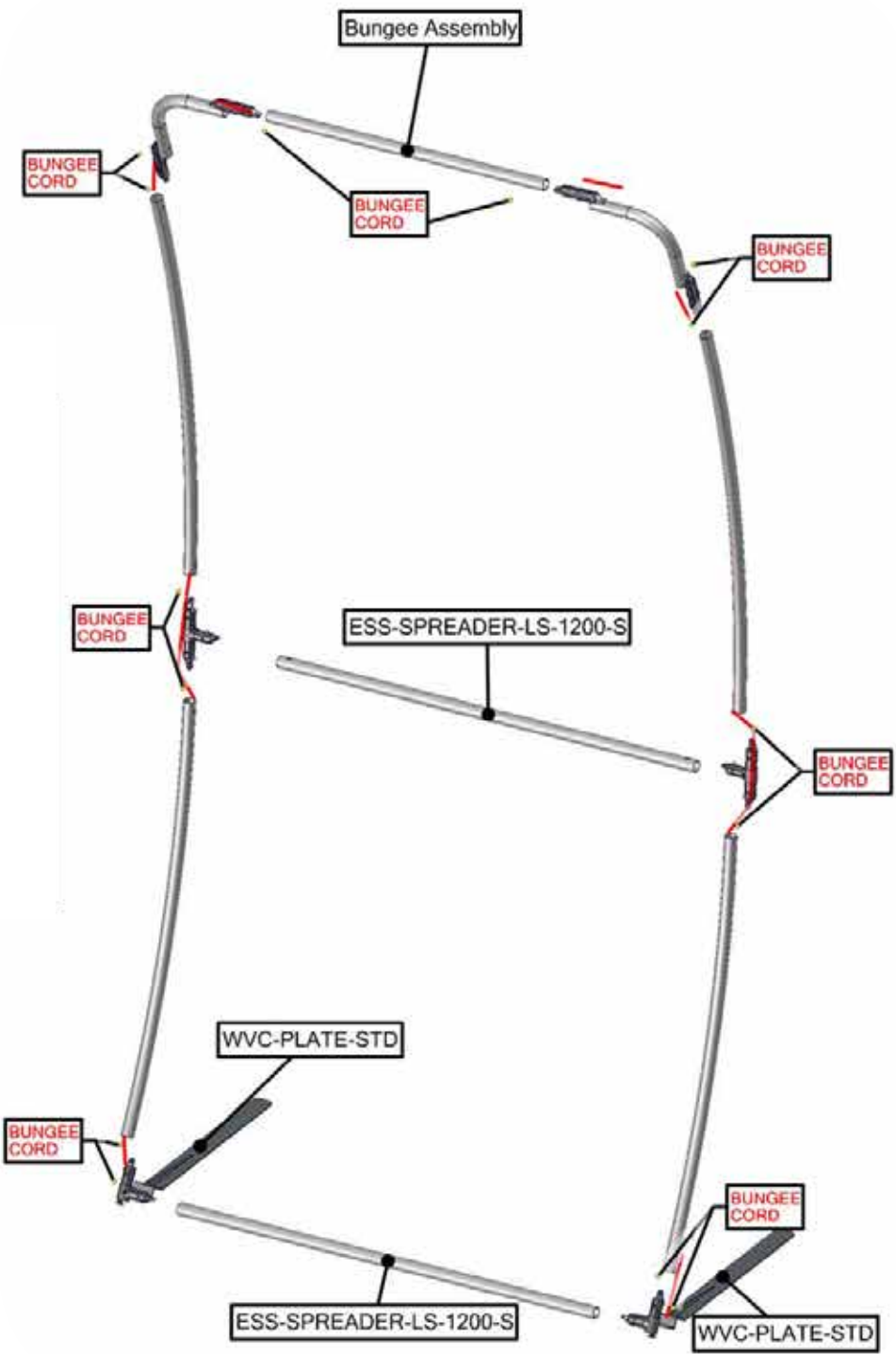

# Design Assembly

## Step by Step

### Step 1.

Assemble the bungee frame.  
Attach the long spreaders.

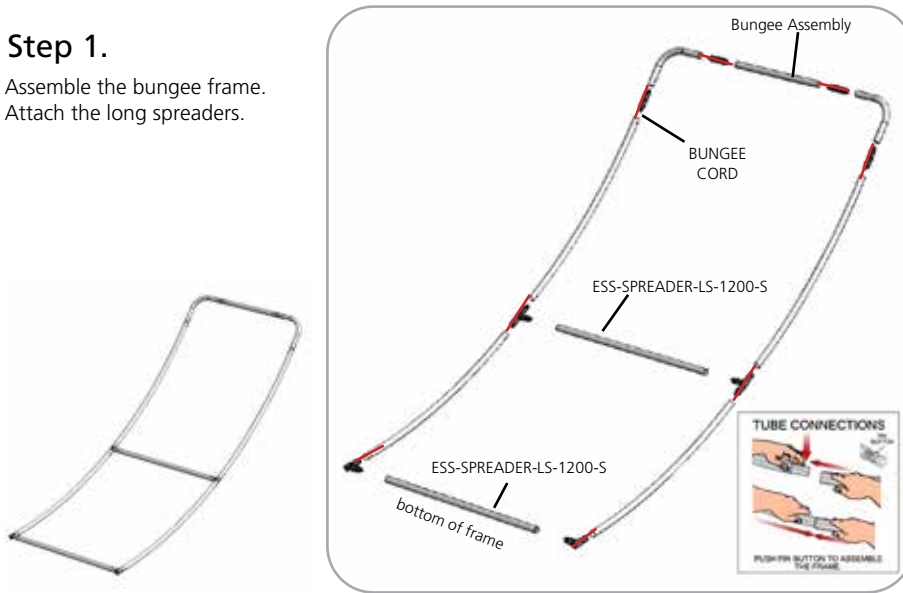

### Step 2.

Slip the graphic over the frame.

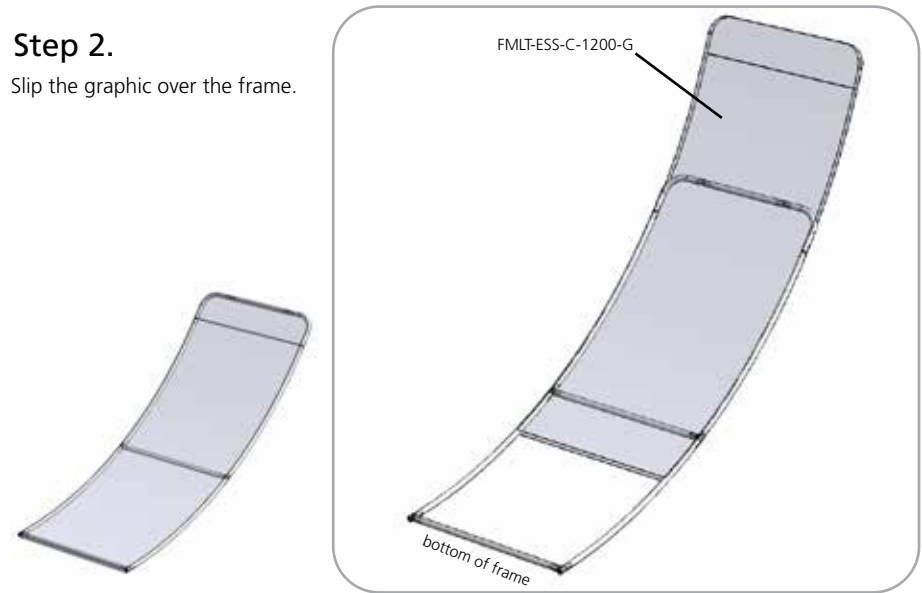

### Step 3.

Attach the stabilizing bases.

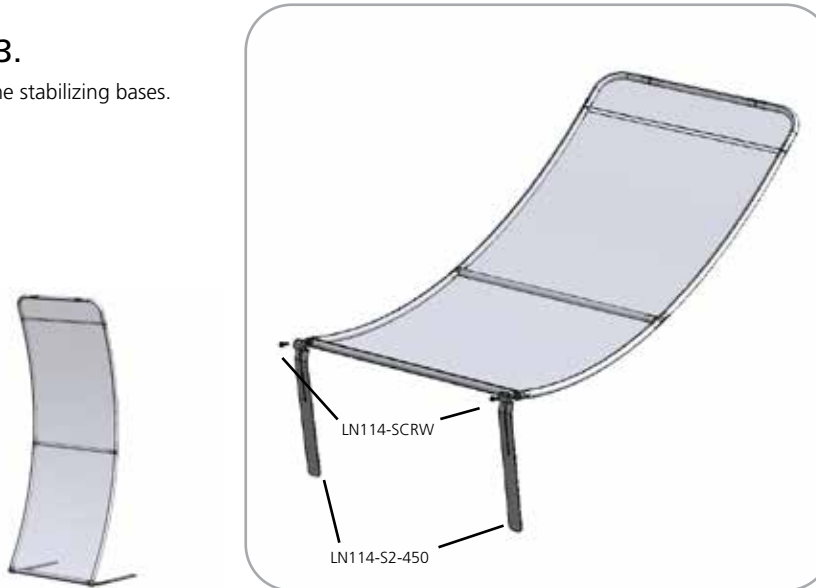

### Step 4.

Setup is complete.

